

LEGEND:

- EXISTING TREE WITH BRICK INSIDE CONCRETE CHAB PUMP CHAMBER
- EXISTING PROJECT PARCELS PROPERTY LINE
- EXISTING PIPE OF PIN FOUND OR SET (AS NOTED)
- EXISTING PUMP CHAMBER
- EXISTING MANHOLE
- EXISTING LAMP POST
- EXISTING LIGHT ON BUILDING OR UTILITY POLE
- EXISTING OVERHEAD WIRES
- EXISTING UTILITY POLE
- EXISTING CITY WIRE (ANCHORS)
- EXISTING CONC. ISLAND / SIDEWALK
- EXISTING LANDSCAPED AREA
- EXISTING BRICK
- EXISTING STONE WALL
- EXISTING LANDSCAPE STONE
- EXISTING CONCRETE
- EXISTING WATER MAIN
- EXISTING WATER WITH GATE VALVE OR SHUTOFF
- EXISTING BUILDING
- EXISTING BUILDING OVERHANG
- EXISTING FILLER
- EXISTING YELLOW STRIPING
- EXISTING EXISTING HAND-CAAP PARKING
- EXISTING SIGNS ON POSTS
- EXISTING CONCRETE CURB
- EXISTING PIPE AND DIRECTION OF FLOW
- EXISTING CONTOUR MAJOR
- EXISTING CONTOUR MINOR
- EXISTING CONTOUR COMPANER
- EXISTING SETBACK LINE
- EXISTING FEATURES TO BE REMOVED FROM SITE

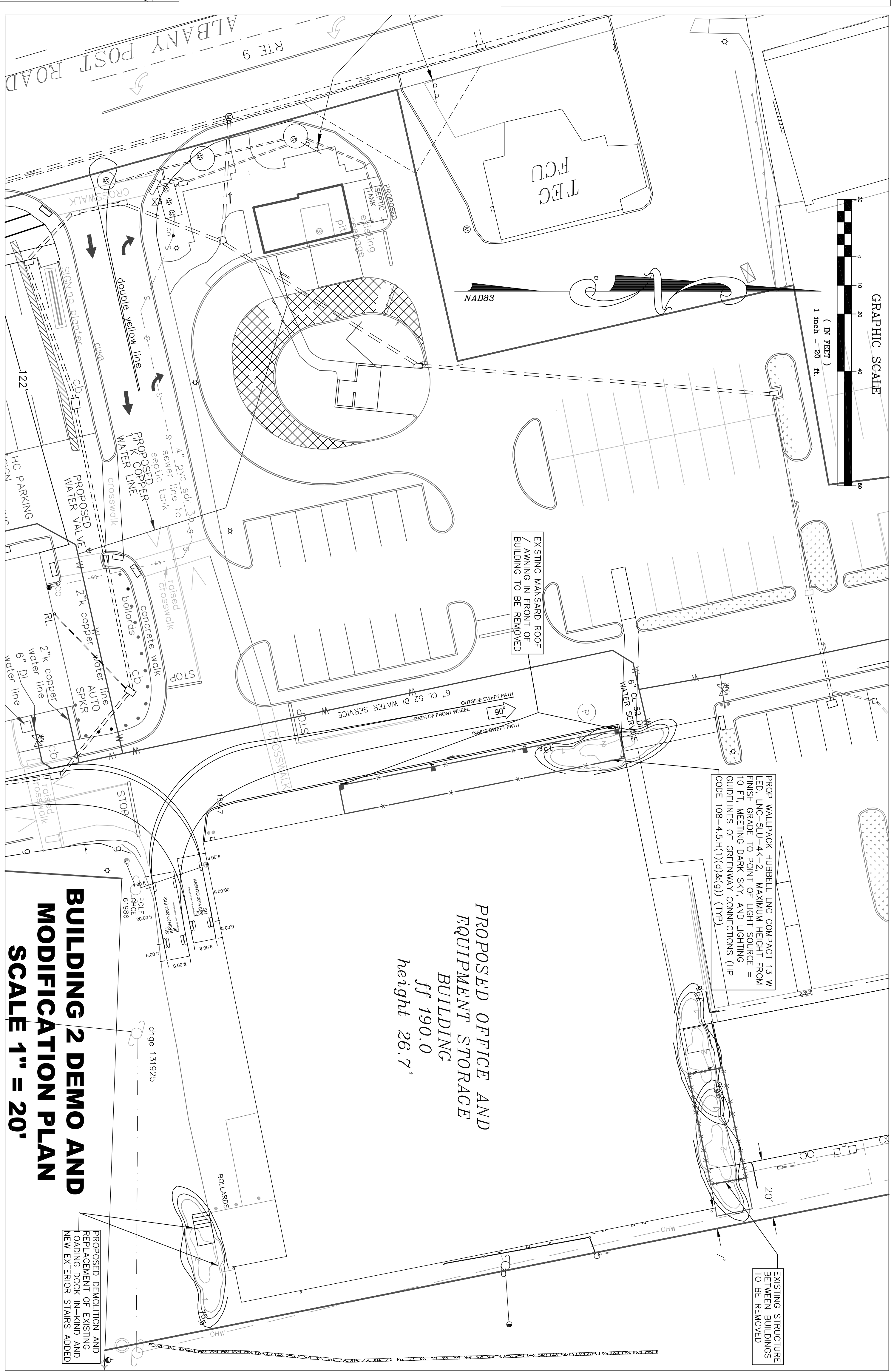

SITE DATA:
Parcel Number: 132200-6065-04-933017-0000
Associated Grid Numbers (lease codes):
6065-04-933017-0001
6065-04-933017-0002
6065-04-933017-0003
6065-04-933017-0004
6065-04-933017-0005
Parcel Address - 4272-4288 Albany Post Rd
Hyde Park 125380000
Owner Name: N & N Hyde Park LLC, (Primary)
Primary (P) Owner Mailing Address 1089 Little Britain Rd New Windsor NY 125530000
ZONING DISTRICT TC
FIRE DISTRICT HYDE PARK FIRE
SCHOOL DISTRICT HYDE PARK CENTRAL
LIGHT DISTRICT HYDE PARK CONSOLIDATED LIGHT - 149
WATER DISTRICT DUTCHESS COUNTY WATER AND WASTE
WATER AUTHORITY

PROPOSED OFFICE AND EQUIPMENT STORAGE BUILDING
ff 190.0
height 26.7'

BUILDING 2 DEMO AND MODIFICATION PLAN
SCALE 1" = 20'

No.	DATE	REVISIONS	BY	Date

01/13/22
Sheet
DEMO 1

BERGER ENGINEERING AND SURVEYING
100 FULTON AVE.
POUGHKEEPSIE N.Y. 12603
(845) 471-7383
bergereng@gmail.com



OWNER/APPLICANT
N&N HYDE PARK LLC
1089 LITTLE BRITAIN RD
NEW WINDSOR NY

HYDE PARK TOWN CENTER - NORTH
4272-4288 Albany Post Rd
Town of Hyde Park
Dutchess County
State of New York

BUILDING 2 DEMO AND MODIFICATION PLAN