

Camp Victory Lake – Religious Sanctuary
2021/2022 Building Location Modification

2020 Building Layout

(Presented to Hyde Park Fire District on 2/2/2021)

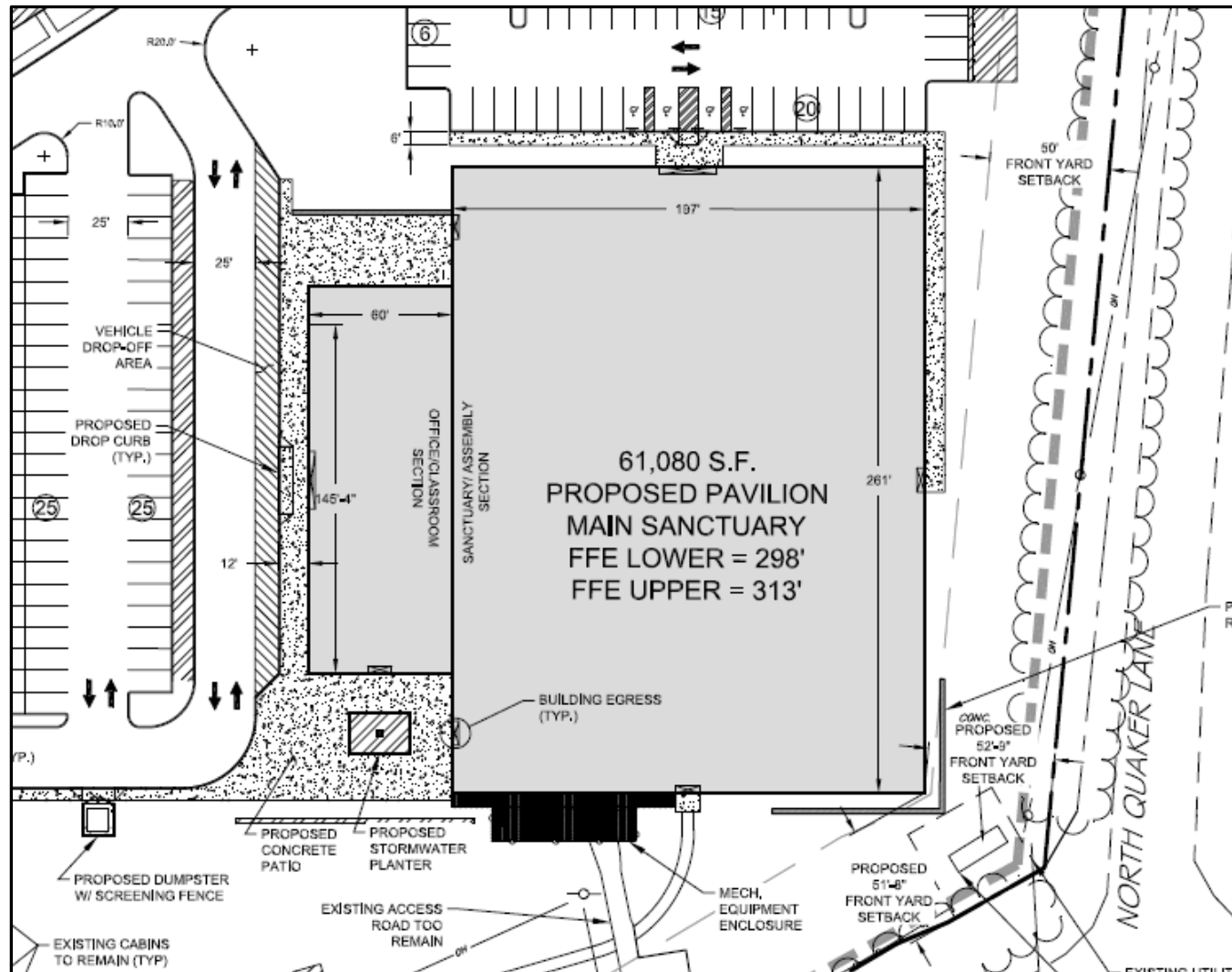

2022 Building Layout

(Modified per Hyde Park Fire District Comments)

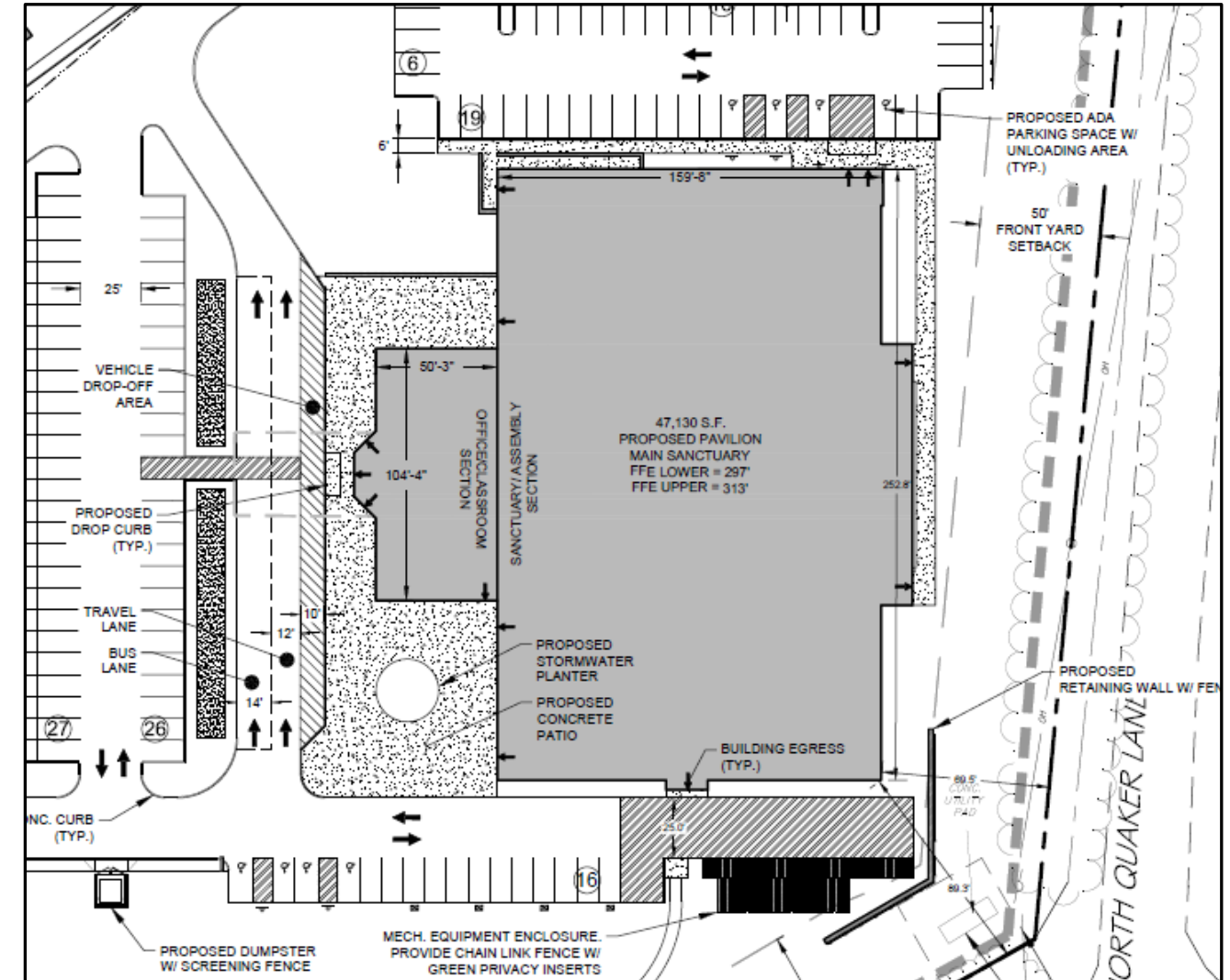

Emergency Access Modifications

- 1) 25' Emergency vehicle access lane added to the South of the Structure.
- 2) 20' of additional clearance provided between structure and retaining wall.
- 3) Building setback from Crum Elbow/North Quaker increased from 51'8" / 52'9" → 89'3.5" / 69'6".