

PROJECT LOCATION MAP

SCALE: 1" = 2000'

Zoning District: Neighborhood Business District
 Proposed Use: Veterinary Clinic
 Special Districts:
 - Hyde Park Central School District
 - Staatsburg Engine Company #2
 - Hyde Park Water System - Water District

BULK ZONE REGULATIONS (NBD)

Maximum Impervious Coverage: 70% (9.54% Proposed)
 Maximum Building Height: 40 Feet (30 Feet Proposed)
 Minimum Front Yard: 20 Feet
 - 92 Feet to Building Proposed for Route 9
 - 20 Feet to Building Proposed for S.Cross Rd.
 Minimum Side Yard: 10 Feet (22 Feet Proposed)
 Minimum Rear Yard: 20 Feet (20 Feet Proposed)
 Scale (gsf): 7,500 gsf (6,235 gsf Proposed)

**TOWN OF HYDE PARK
 PLANNING BOARD APPROVAL
 OWNER/APPLICANT SIGNATURES**

THE UNDERSIGNED APPLICANT OF THE PROPERTY AND THE UNDERSIGNED OWNER OF THE PROPERTY HEREOF, STATE THAT THEY ARE FAMILIAR WITH THIS MAP, ITS NOTES AND ITS CONTENTS, AND HEREBY CONSENT TO ALL SAID TERMS AND CONDITIONS AS STATED HEREOF.

THE APPLICANT AND OWNER UNDERSTAND THEIR OBLIGATION TO THE TOWN TO KEEP THE SITE AS PER SITE PLAN APPROVAL BY THE TOWN PLANNING BOARD UNTIL A NEW OR REVISED SITE PLAN IS APPROVED FOR THE SITE. THE APPLICANT AND OWNER UNDERSTAND THEIR OBLIGATION TO THE TOWN NOT TO OCCUPY THE PREMISES BEFORE A CO IS ISSUED BY THE TOWN BUILDING DEPARTMENT.

OWNER _____ DATE _____

APPLICANT _____ DATE _____

**AMENDED SITE PLAN FOR
 H & A VETERINARY ASSOCIATES**

TAX MAP # 07-6066-02-878695
 4938 ALBANY POST ROAD
 TOWN OF HYDE PARK
 DUTCHESS COUNTY, NEW YORK

SHEET	SCALE	DATE	BY:
1 OF 1	1" = 20'-0"	08/13/19	PAUL TIRUMS, P.E. 16 FRIENDSHIP LANE POUGHKEEPSIE, N.Y. 12601

Revised: 9/17 2019

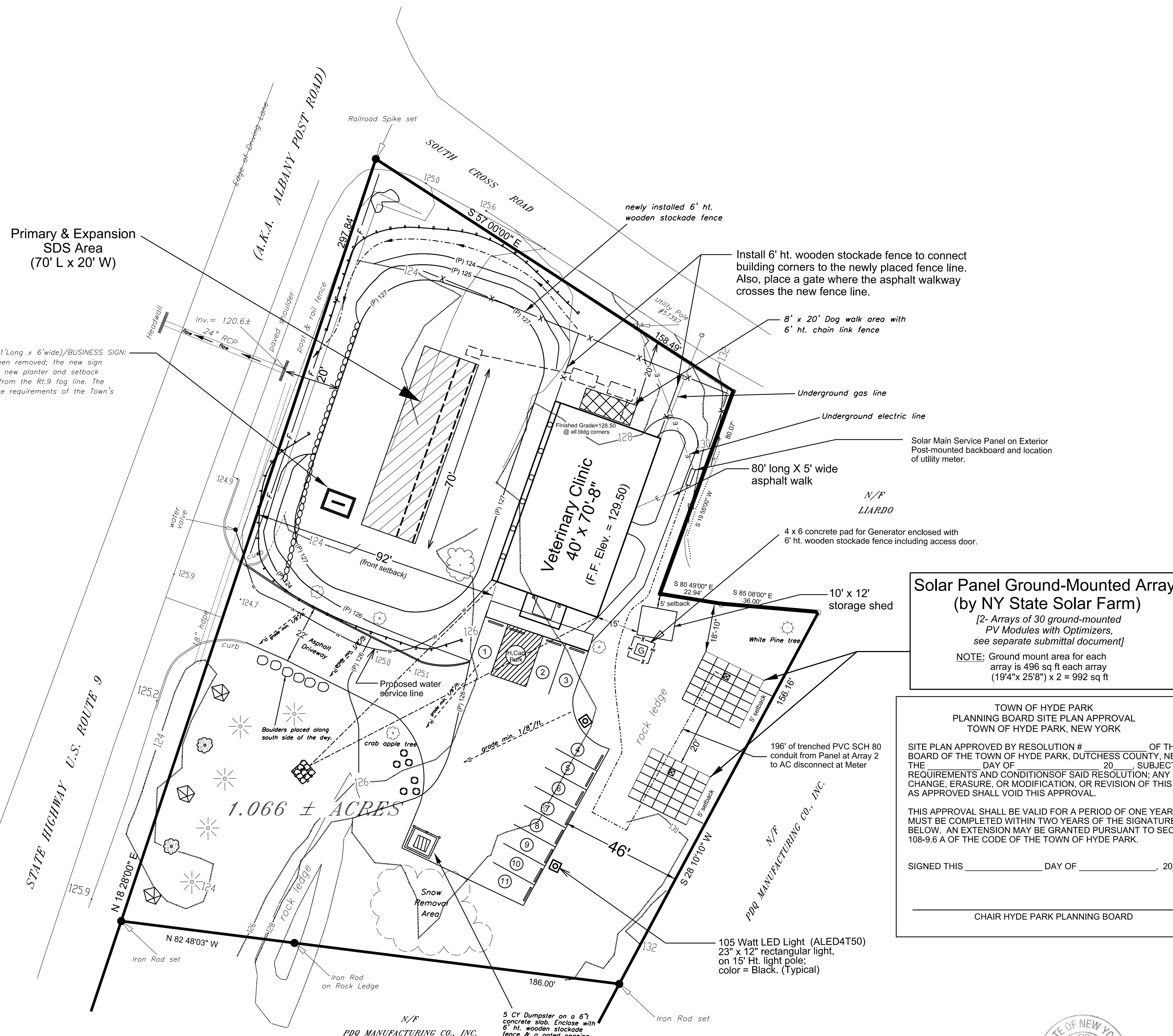

LEGEND

EXISTING CONTOURS	---
PROPOSED CONTOURS	---
SILT FENCE	—
WATER LINE	—
DRAINAGE SWALE	---
WOOD STOCKADE FENCE	—
POST & RAIL FENCE	—

LOCATION OF NEW PLANTER (11' Long x 6' wide)/BUSINESS SIGN:
 Existing sign & planter has been removed; the new sign post will be located within the new planter and setback such that it is 15' minimum from the Rt.9 fog line. The sign will be lighted meeting the requirements of the Town's Zoning Codes.

Table of Parking Spaces

Type	Quantity
Veterinary Employees (8' x 18' typ.)	5
Customers/Patients (9' per doctor)	6
Handi-Cap	1

Parking Lot Luminaire Schedule

Symbol	Qty.	Lumens/Lamp	LLF	Description
☐	2	7,195	0.45	ALED 4T50

See Plan Sheet 3 for Building's Exterior Lighting shown on Floor Plan.
Pole & Lighting Details: Mounting Height = 15'-0"; 4" x 4" Square Steel Shaft (55,000 psi); Wall thickness = 7 Gauge; Bolt Diam. = 3/4"; Anchor Bolts - Grade 55 Steel; Color = Black. Note: The lighting fixtures, metal shielding shall all match and be the same color and finishing as the poles - powder coated black.

Landscape Maintenance Notes:

- Any dead or diseased trees or shrubs shall be replaced in kind during the nearest Spring or Fall planting season.
- During the trees and shrubs first year they shall be watered at least every other week in which there is less than 1/2" of rain.
- Mulch Planting Beds shall be kept free of weeds. The mulch beds shall be replenished with new mulch as necessary to maintain the 3" mulch depth.
- The Owner shall remain responsible for the maintenance of the landscaping for the life of the site. This includes but is not limited to replacing dead plant material, re-mulching the plant areas, and keeping the landscaping weed free.
- The entire septic system/fill area located in front (west) of the building shall be covered with topsoil and seeded and mulched for the establishment of grass. No plantings is allowed in this area.
- The concrete curb stops shall be re-anchored if they are moved out of place and they shall be replaced if they are damaged for the life of the site.

Landscape/Planting Schedule

Symbol	Qty.	Botanical Name	Size
☉	6	Red/Yellow Twig Dogwood	2 Gallon
☐	3	Hop Hornbeam	2 - 3 inch caliper
☐	2	ServiceBerry/Shadblow	2 - 3 inch caliper
☐	5	Norway Spruce	5-6 ft. height

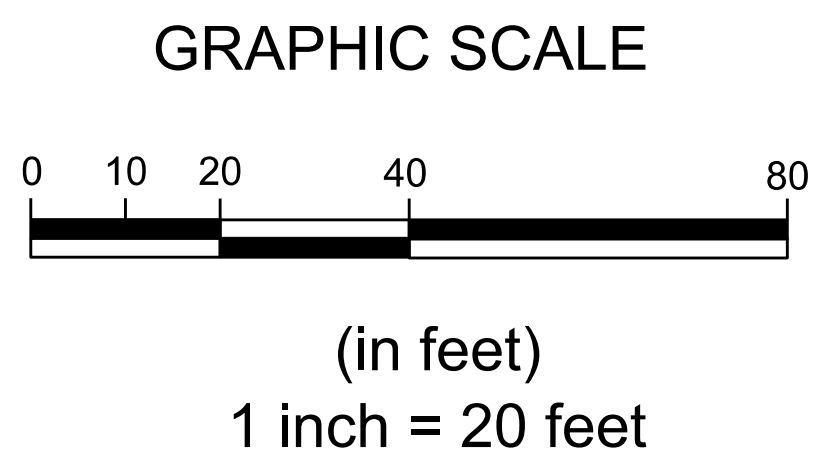

All property line and topography information by:
MICHAEL DALBO, LAND SURVEYOR
 19 SHADOW LANE
 POUGHKEEPSIE, NY 12601
 (845) 229-9383
 May 12, 2016 and Aug. 11, 2016



OWNER'S NAME & ADDRESS
 H & A Veterinary Associates
 Realty, LLC.
 (Mr. Howard Mintzer)
 24 Mountain View Road
 Staatsburg, N.Y. 12580