

NYS ROUTE 9G (aka VIOLET AVENUE)

HYDE PARK ALF REALTY LLC  
DOC #02 2012 1897  
6163-04-596391

NEW YORK STATE  
DOC #02 2012 1897  
6163-04-66414

AREA = 9.788 ACRES

TACONIC REALTY ASSOC.  
DEED BOOK 1953, PAGE 209  
6163-04-60353

S 02°46'20" W  
415.75'

UNAUTHORIZED ALTERATION OR ADDITION TO A SURVEY MAP BEARING A LICENSED LAND SURVEYOR'S SEAL IS A VIOLATION OF SECTION 7209, SUB-DIVISION 2, OF THE NEW YORK STATE EDUCATION LAW.  
ONLY COPIES OF THE ORIGINAL OF THIS SURVEY MAP MARKED WITH AN ORIGINAL OF THE LAND SURVEYOR'S INKED SEAL OR HIS EMBOSSED SEAL SHALL BE CONSIDERED TO BE VALID TRUE COPIES.  
IT IS HEREBY CERTIFIED THAT THIS SURVEY WAS PREPARED IN ACCORDANCE WITH THE EXISTING CODE OF PRACTICE FOR LAND SURVEYORS ADOPTED BY THE NEW YORK STATE ASSOCIATION OF PROFESSIONAL LAND SURVEYORS.  
CERTIFICATIONS INDICATED HEREON SIGNIFY THAT THIS SURVEY WAS PREPARED IN ACCORDANCE WITH THE EXISTING CODE OF PRACTICE FOR LAND SURVEYORS. SAID CERTIFICATIONS SHALL BE IN WHOLE ONLY TO THE PERSON FOR WHOM THE SURVEY IS PREPARED, AND ON HIS BEHALF TO THE TITLE COMPANY, LENDING INSTITUTION AND THE GOVERNMENTAL AGENCIES LISTED HEREON, AND TO THE ASSIGNEES OF THE LENDING INSTITUTION. CERTIFICATIONS ARE NON-TRANSFERABLE TO ADDITIONAL INSTITUTIONS OR SUBSEQUENT OWNERS.  
SURVEYED AS PER MAPS AND DEEDS OF RECORD AND AS IN INDICATED POSSESSION ON OR BEFORE NOVEMBER 14, 2017.  
THIS SURVEY WAS PREPARED WITHOUT BENEFIT OF AN ABSTRACT OF TITLE REPORT AND IS SUBJECT TO WHATEVER STATE OF FACTS SUCH A REPORT MAY REVEAL.

BOUNDARY & TOPOGRAPHICAL SURVEY

TACONIC REALTY ASSOCIATES

TOWN OF HYDE PARK  
NOVEMBER 29, 2017

DUTCHESS COUNTY, NEW YORK  
1" = 30'

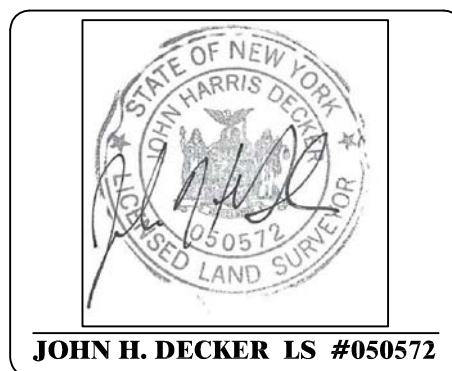

- LEGEND**
- PROPERTY BOUNDS
  - OH — OVERHEAD WIRES
  - STONEWALL
  - POST & RAIL FENCE
  - STOCKADE FENCE
  - UTILITY POLE
  - CLEANOUT
  - SIGN
  - CATCH BASIN
  - WATER VALVE
  - PROPERTY ANGLE
  - LIGHT POLE
  - HYDRANT
  - WELL
  - SEWER MANHOLE

**DECKER SURVEYING**  
JOHN H. DECKER IS  
293 FALGOUT LANE  
RED HOOK NY 12571  
Phone No. (845) 758-4442  
decker@deckersurveying.com  
Copyright 2005

RCPM LLC  
DOC #02 2003-4-3205  
6163-04-569324

SOME UTILITIES WERE TAKEN FROM A SITE PLAN PREPARED BY THE CLIENT COMPANIES FOR PACE PARK, DATED 5-24-99. ALL UNDERGROUND UTILITIES SHOULD BE FIELD VERIFIED.  
VERTICAL DATUM IS APPROXIMATE NAVD 88 DATUM IS APPROXIMATELY 6.7' HIGHER THAN ABOVE REFERENCED SITE PLAN