

PROJECT LOCATION MAP
SCALE: 1" = 2000'

Zoning District: Neighborhood Business District
Proposed Use: Veterinary Clinic
Special Districts:
- Hyde Park Central School District
- Staatsburg Engine Company #2
- Hyde Park Water System - Water District

BULK ZONE REGULATIONS (NBD)

Maximum Impervious Coverage: 70% (9.54% Proposed)
Maximum Building Height: 40 Feet (30 Feet Proposed)
Minimum Front Yard: 20 Feet
- 92 Feet to Building Proposed for Route 9
- 20 Feet to Building Proposed for S.Cross Rd.
Minimum Side Yard: 10 Feet (22 Feet Proposed)
Minimum Rear Yard: 20 Feet (20 Feet Proposed)
Scale (gsf): 7,500 gsf (6,661 gsf Proposed)

Notes: 1. The Veterinary Clinic business will not operate as a boarding kennel.
2. See Plan Sheet #3 of 3 for Bulk Scale calculations Table.

TOWN OF HYDE PARK
PLANNING BOARD APPROVAL
OWNER/APPLICANT SIGNATURES

THE UNDERSIGNED APPLICANT OF THE PROPERTY AND THE UNDERSIGNED OWNER OF THE PROPERTY HEREOF, STATE THAT THEY ARE FAMILIAR WITH THIS MAP, ITS NOTES AND ITS CONTENTS, AND HEREBY CONSENT TO ALL SAID TERMS AND CONDITIONS AS STATED HEREOF.

THE APPLICANT AND OWNER UNDERSTAND THEIR OBLIGATION TO THE TOWN TO KEEP THE SITE AS PER SITE PLAN APPROVAL BY THE TOWN PLANNING BOARD UNTIL A NEW OR REVISED SITE PLAN IS APPROVED FOR THE SITE. THE APPLICANT AND OWNER UNDERSTAND THEIR OBLIGATION TO THE TOWN NOT TO OCCUPY THE PREMISES BEFORE A CO IS ISSUED BY THE TOWN BUILDING DEPARTMENT.

OWNER _____ DATE _____
APPLICANT _____ DATE _____

TOWN OF HYDE PARK
PLANNING BOARD SITE PLAN APPROVAL
TOWN OF HYDE PARK, NEW YORK

SITE PLAN APPROVED BY RESOLUTION # _____ OF THE PLANNING BOARD OF THE TOWN OF HYDE PARK, DUTCHESS COUNTY, NEW YORK, THE DAY OF _____ 20____ SUBJECT TO ALL REQUIREMENTS AND CONDITIONS OF SAID RESOLUTION; ANY CHANGE, ERASURE, OR MODIFICATION, OR REVISION OF THIS SITE PLAN AS APPROVED SHALL VOID THIS APPROVAL.

THIS APPROVAL SHALL BE VALID FOR A PERIOD OF ONE YEAR AND MUST BE COMPLETED WITHIN TWO YEARS OF THE SIGNATURE DATE BELOW. AN EXTENSION MAY BE GRANTED PURSUANT TO SECTION 108-9.6 A OF THE CODE OF THE TOWN OF HYDE PARK.

SIGNED THIS _____ DAY OF _____, 20____

CHAIR HYDE PARK PLANNING BOARD

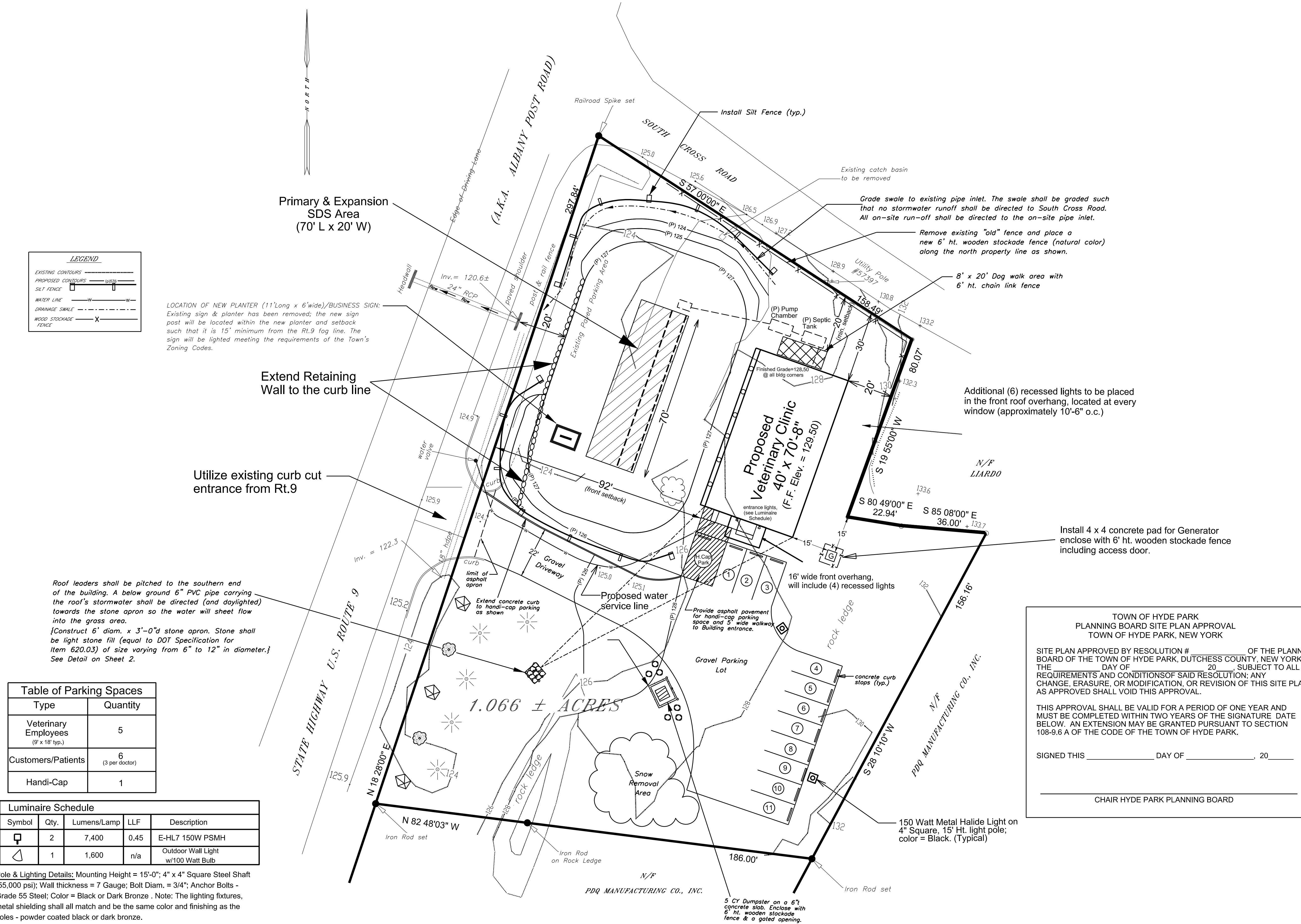

LEGEND

- EXISTING CONTOURS
- PROPOSED CONTOURS
- SILT FENCE
- WATER LINE
- DRAINAGE SWALE
- WOOD STOCKADE FENCE

Table of Parking Spaces

Type	Quantity
Veterinary Employees (9' x 18' typ.)	5
Customers/Patients (3 per doctor)	6
Handi-Cap	1

Luminaire Schedule

Symbol	Qty.	Lumens/Lamp	LLF	Description
☐	2	7,400	0.45	E-HL7 150W PSMH
△	1	1,600	n/a	Outdoor Wall Light w/100 Watt Bulb

Pole & Lighting Details: Mounting Height = 15'-0"; 4" x 4" Square Steel Shaft (55,000 psi); Wall thickness = 7 Gauge; Bolt Diam. = 3/4"; Anchor Bolts - Grade 55 Steel; Color = Black or Dark Bronze. Note: The lighting fixtures, metal shielding shall all match and be the same color and finishing as the poles - powder coated black or dark bronze.

Outdoor Wall Lighting Details: Lantern Style; Mounting Height = 6'-6"; Color = Black or Dark Bronze. 100 Watt Bulb Max.; Die-cast Aluminum fixture in Black or dark bronze.

Landscape/Planting Schedule

Symbol	Qty.	Botanical Name	Size
○	6	Red/Yellow Twig Dogwood	2 Gallon
◇	3	Hop Hornbeam	2 - 3 inch caliper
⊗	2	ServiceBerry/Shadblow	2 - 3 inch caliper
✱	5	Norway Spruce	5-6 ft. height

- Landscape Maintenance Notes:**
- Any dead or diseased trees or shrubs shall be replaced in kind during the nearest Spring or Fall planting season.
 - During the trees and shrubs first year they shall be watered at least every other week in which there is less than 1/2" of rain.
 - Mulch Planting Beds shall be kept free of weeds. The mulch beds shall be replenished with new mulch as necessary to maintain the 3" mulch depth.
 - The Owner shall remain responsible for the maintenance of the landscaping for the life of the site. This includes but is not limited to replacing dead plant material, re-mulching the plant areas, and keeping the landscaping weed free.
 - The entire septic system/fill area located in front (west) of the building shall be covered with topsoil and seeded and mulched for the establishment of grass. No plantings is allowed in this area.
 - The concrete curb stops shall be re-anchored if they are moved out of place and they shall be replaced if they are damaged for the life of the site.

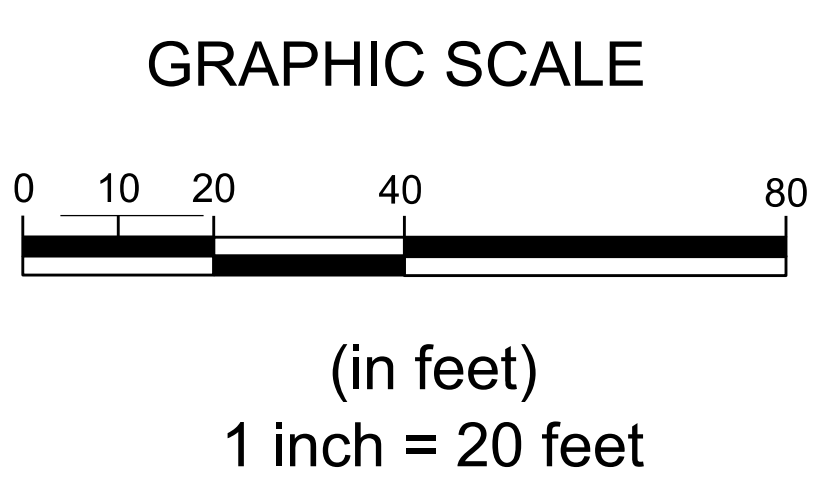

All property line and topography information by:
MICHAEL DALBO, LAND SURVEYOR
19 SHADOW LANE
POUGHKEEPSIE, NY 12601
(845) 229-9383
May 12, 2016 and Aug. 11, 2016

OWNER'S NAME & ADDRESS
H & A Veterinary Associates
Realty, LLC.
(Mr. Howard Mintzer)
24 Mountain View Road
Staatsburg, N.Y. 12580

**AMENDED SITE PLAN FOR
H & A VETERINARY ASSOCIATES
FOR NEW OFFICE BUILDING**

TAX MAP # 07-6066-02-878695
4938 ALBANY POST ROAD
TOWN OF HYDE PARK
DUTCHESS COUNTY, NEW YORK

SHEET	SCALE	DATE	BY:
1 OF 3	1" = 20'-0"	09/29/16	PAUL TIRUMS, P.E. 16 FRIENDSHIP LANE POUGHKEEPSIE, N.Y. 12601

Revised: 12/28/16, 01/29, 02/21 & 03/28/17 AMENDED: January 30, 2018